

WarriorElite™



**EL(P)C(HB) -50NA/70NA
WarriorElite™**

PRODUCT DESCRIPTION

The WarriorElite™ is Videolarm's next generation of vandal-resistant cameras. This all-in-one package features a cast aluminum housing protecting a hi-res color or day/night camera. The 3" polycarbonate dome is built to resist up to a 10 lb. sledgehammer strike. Each WarriorElite™ is also environmentally sealed, making it perfect for virtually any application, indoors or outdoors. The hi-res color or day/night camera sits in a three-axis camera bracket can be easily adjusted or removed to access internal electronics.



CAMERA FEATURES

- Includes High-res Color or Day/Night camera
- 480 Horizontal lines of TV Resolution
- 1/4" CCD
- Minimum resolution - Color 2.0 lux (f1.2)
B/W 0.09 lux (f1.2) Switches to B/W at 0.06 lux
- Auto-iris 3-9mm Vari-focal lens
- NVT available
- Pan/tilt/zoom available

HOUSING FEATURES



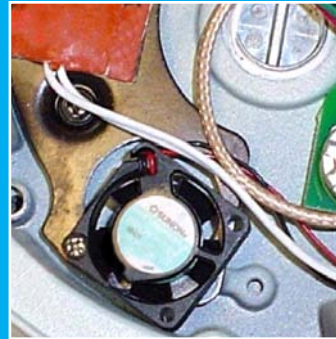

- Vandal-resistant cast aluminum construction
- 3" polycarbonate clear dome with liner
- Unique 3-axis camera bracket
- Environmentally sealed
- Optional wall mount and pendant mount
- 24 VAC heater/blower available

**Thermostatically
Controlled
Heater / Blower
Option**



circulates hot air to the bottom of the dome unit giving the Elite superior performance levels in all weather conditions.

OPTIONAL COMPONENTS AND ACCESSORIES:

			
ELWA Junction Box Wall Mount for WarriorElite series	ELCPA Corner/Pole Mount to be used with Elite Wall Mount (ELWM)	ELTMC Test monitor cable harness (WarriorElite fixed cameras only)	PS2440 Plug-in wall transformer 24Vac, 40vA



ELWM Wall Mount

ELPM Pendant Mount

WarriorElite™ Models:

WarriorElite™	Day / Night Camera	Color Camera	Heater / Blower
ELC-50NA		√	
ELCHB-50NA		√	√
ELC-70NA	√		
ELCHB-70NA	√		√

NVT NVT Twisted Pair (add -X2 to Model Number)
ifs IFS Fiber Card (add -X3 to Model Number)

WarriorElite™ Pan / Tilt Models:

WarriorElite™ Pan/Tilt	Day/Night	Color	Heater/Blower
ELPC-50NA		√	
ELPCHB-50NA		√	√
ELPC-70NA	√		
ELPCHB-70NA	√		√

Vandal-Resistant Camera Systems - WarriorElite™

WarriorElite™

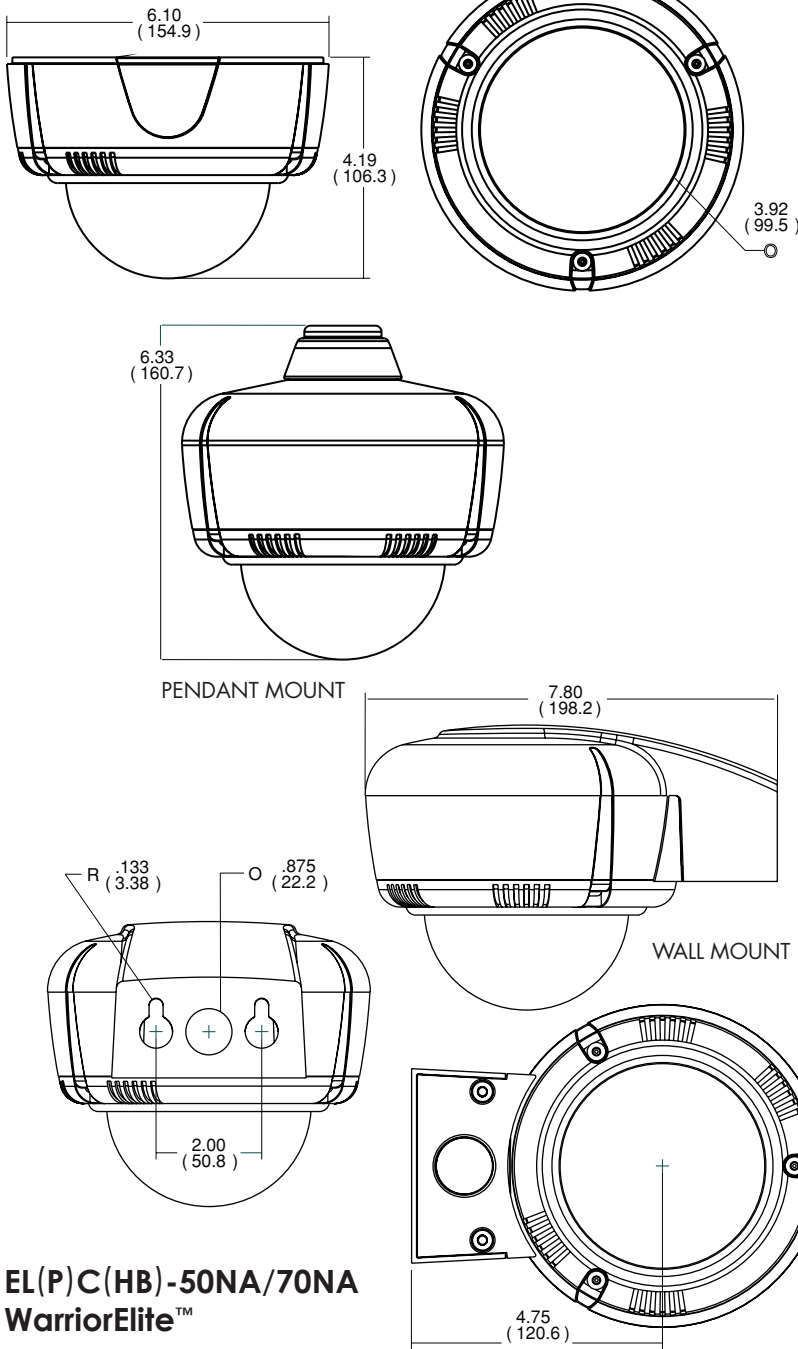

EL(P)C(HB) -50NA/70NA WarriorElite™

ARCHITECTURAL/ENGINEERING SPECIFICATIONS

The vandal-resistant housing shall be manufactured from 3/16" thick cast aluminum with an off-white powder coat finish and shall be environmentally sealed. One 3/4" conduit opening shall be located on a side of the housing and one 1/2" conduit opening shall be located on the back for wiring access. The dome shall be clear, and constructed of 1/8" thick polycarbonate measuring 3.875" in diameter, and shall include a liner. A lanyard shall be provided to attach the dome to the housing to prevent the dome from dropping when opened for service. A three-axis camera bracket shall be included, constructed of high-impact plastic. Adjustments shall include 360° pan of the entire bracket, 180° tilt of the lens bracket, and a 90° tilt of the lower portion of the bracket in instances where the entire housing must be mounted at an angle. The camera bracket shall be held in place inside the housing by three clips, allowing for easy removal to access the power board. The camera shall be a high resolution day/night camera with 480 horizontal lines of TV resolution. Minimum resolution shall be 2.0 lux at F1.2 for color, 0.09 lux at F1.6 for black and white. The camera shall automatically switch from color to black and white operation at 0.06 lux. The lens shall be variable focus, auto iris, with a 3 to 9mm focal length. An optional factory installed NVT twisted pair or IFS fiber module is available. In addition each unit is equipped with a factory installed 24 VAC heater blower unit for extreme outdoor applications. For wall mount applications a wall mount shall be available which shall be constructed of 3/16" cast aluminum with an off-white powder coat finish, and shall provide wire access through the wall mount. A pendant mount adapter shall be available, constructed of 3/16" cast aluminum with an off-white powder coat finish.

Camera Specifications

Signal System:	NTSC or PAL
Imager:	1/4 interline CCD
Scanning System:	2:1 interlaced
Synchronizing System:	Internal
Horizontal Resolution:	480 TV lines
Signal to Noise Ratio:	More than 50dB
Minimum Illumination:	Color 2.0 lux (f 1.2) B/W 0.09 lux (f 1.6) Switches to B/W at 0.06 lux
Video Output:	1Vp-p 75 Ohm
Electronic Iris:	On/off selectable
Auto Iris Control:	DC drive lens, adjustable level
Switchable Shutter Speed:	1/60 sec. Fixed (flickerless off) 1/100 sec. Fixed (flickerless on)
White Balance:	Auto
Flickerless:	On/off selectable
Backlight Compensation:	On/off selectable
Lens:	Auto-iris varifocal

Electrical Specifications

Fixed Camera (without heater/blower)	12 - 28 VDC or 15 - 28 VAC At 12 VDC, 300mA, 3.6W At 24 VAC, 250mA, 6W
Fixed Camera (with heater/blower)	24 VAC, 700mA, 16.8W
Pan/Tilt (without heater/blower)	24 VAC, 750mA, 18W
Pan/Tilt (with heater/blower)	24 VAC, 1.17A, 28W
Video:	BNC 1.0 Vp-p, 75 ohm NVT 1.0 Vp-p, 100 ohm

Environmental Specifications

Temperature Range:	-22° to 140° F (-30° to +60° C)
--------------------	---------------------------------

Dimensions

Base:	3.15" x 4.33" (80mm x 110mm)
Dome:	3.55" (90mm)

Shipping Specifications

Model	Shipping Weight	Box Dimensions
ELC-50NA	4 lbs	7 x 7 x 8