



DESCRIPTION

The **VideoKit™ MR5-5A** fixed camera system is designed to be used in indoor ceiling applications. A hi-res color camera with 2.8-12mm auto iris lens sits inside a low profile 5" clear or tinted dome. The upper body is made of steel, and a white powder coat trim ring gives the MR5 a clean, streamlined look.

FEATURES

- Fixed hi-res color camera with 2.8-12mm auto iris lens
- 5" dome for easy installation and servicing from below the ceiling
- Housing extends only 2.5" below ceiling
- Includes a decorative trim ring with quick-release pressure springs
- Plenum rated metal top
- Units available with either clear or tinted dome (1 F stop light reduction)

CERTIFICATIONS

- Complies with Part 15 of the FCC Rules

ARCHITECTURAL/ENGINEERING SPECIFICATIONS

The VideoKit™ MR5-5A shall be a fixed camera system housed inside a recessed ceiling mount enclosure. A hi-res color camera with 2.8-12mm auto iris lens shall be included. The camera shall have a horizontal resolution of 460 TV lines, with a minimum illumination of 1.2 Lux in normal mode and 0.8 Lux in hi gain mode at F1.2. The back box shall be constructed from 18-gauge steel and be capable of being installed in its entirety from below the ceiling. It shall be held in place by two spring steel clips. The lower dome shall be cell-cast acrylic and shall be available either clear or tinted. The tinted dome shall have 1 F-stop light reduction. The lower dome shall be held in place by an ABS plastic trim ring. The MR5 shall be designed to be installed in either sheetrock or drop ceilings.

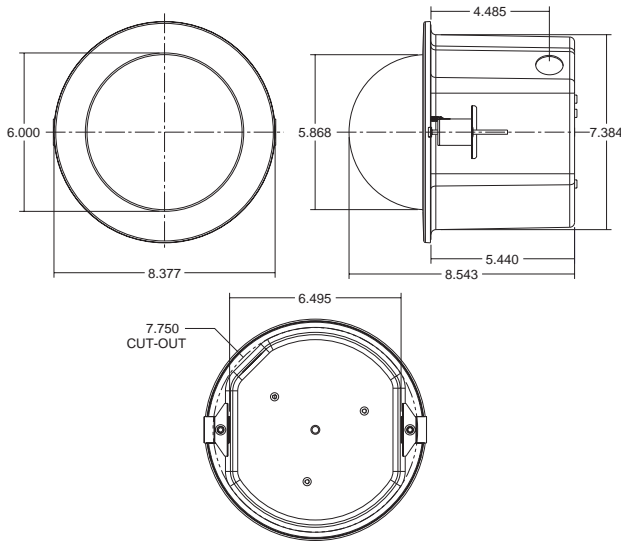

MODELS

MR5-5A - Indoor recessed ceiling fixed camera system with hi-res color camera, 2.8-12mm auto iris lens, 24 VAC input, plenum rated metal back box, clear or tinted cell-cast acrylic dome, decorative trim ring

ELECTRICAL SPECIFICATIONS

Power Input - 24 VAC

Power Consumption

Camera - 5 watts (208mA)

CAMERA SPECIFICATIONS - see page 40

SHIPPING SPECIFICATIONS

Model	Unit Weight	Shipping Weight	Shipping Box Dim.
MR5-5A	10 lbs	10 Grd/14 Air	15 x 15 x 12

* Shipping weights depend on box dimensions.



CAMERA SPECIFICATIONS

- Power Input - 24 VAC
- Image Sensor - Interline 1/3" Sony Super HAD CCD
- Scanning System - 2:1 Interlaced
- Sync System - Internal/Linelock (Switchable)
- Horizontal Resolution - 460 TV Lines
- Signal to Noise Ratio - 48db or more (AGC off)
- Minimum Resolution (F1.2) - 1.2 Lux Normal Mode
0.8 Lux Hi Gain Mode
- Gain Control - Automatic
- Backlight Compensation - Center Zone Detection (on/off switchable)
- White Balance - Automatic/Hold (push lock)
- Dimensions - 1.9" (H) x 1.9" (W) x 3.3" (L)

Super HAD CCD is a registered trademark of Sony Corporation

LENS SPECIFICATIONS

2.8 - 12mm Lens

- Focal Length - 2.8 to 12mm
- Iris Range - F1.4 to 360
- Iris Operation - Auto Iris
- Focus Operation - Manual
- Diameter - 1.57"
- Length - 2.2"

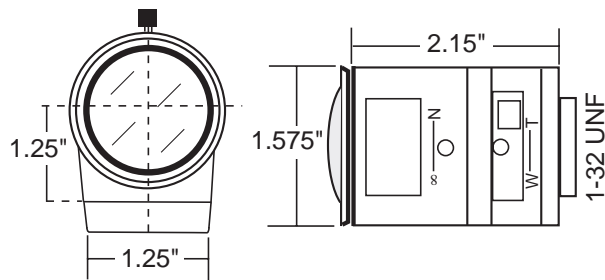

5 - 50mm Lens

- Focal Length - 5 to 50mm
- Iris Range - F1.4 to 185
- Iris Operation - Auto Iris
- Focus Operation - Manual
- Diameter - 1.7"
- Length - 2.3"

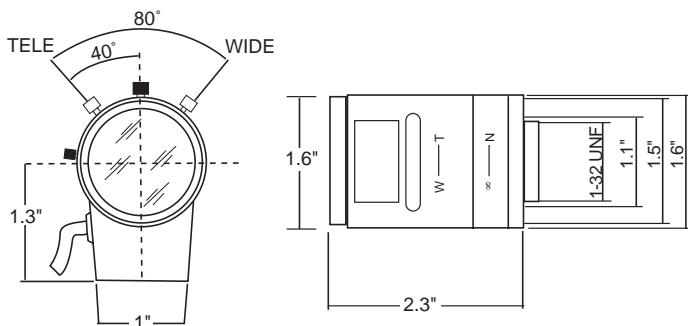

Neither the camera nor lens is available as a separately ordered item