

RECESSED CEILING MOUNT DOMES - MiniPan™ MP121/141



DESCRIPTION

The MiniPan™ Recessed is a general purpose indoor dome camera housing. It's designed for use with fixed position or pan/tilt/zoom cameras, and is ideal for standard body black and white or color cameras. The 12" and 14" diameter domes can be ordered clear or tinted, with an inner liner available as an option. Other options include a continuous rotation, integral receiver and a variable, high speed pan/tilt drive with presets.

FEATURES

- MP121 houses single and the MP141 multiple fixed cameras
- Options include a choice of standard fixed speed or high performance variable speed pan/tilt drives
- The MP121 is available with scanner
- Available with clear or tinted domes
- Inner liner available
- Standard white or optional brass finish trim rings
- Easy to install and service

CERTIFICATIONS



ARCHITECTURAL/ENGINEERING SPECIFICATIONS

The domed housing shall be designed for suspended or sheet rock ceilings. The MP121 housing shall accept a maximum camera and lens length of 8" with liner, 9" without. The MP141 housing shall accept a maximum camera length of 11" for one and 8" for two cameras without the liner. With the liner, the maximum camera length shall be 10" for one and 7" for two cameras. The back box shall be constructed from 20-gauge steel, and the bracket shall be made from 14-gauge steel, meeting fire codes. The lower dome shall be constructed from .125" acrylic (94HB rating). The housing shall be available with either a clear or tinted dome. The tinted dome shall have approximately 1 F-stop of light reduction. A pan/tilt motor shall be an integral option of the housing. The optional pan/tilt shall have a pan speed of 12°/second, with a tilt speed of 12°/second. Presets and slip rings shall also be optional.

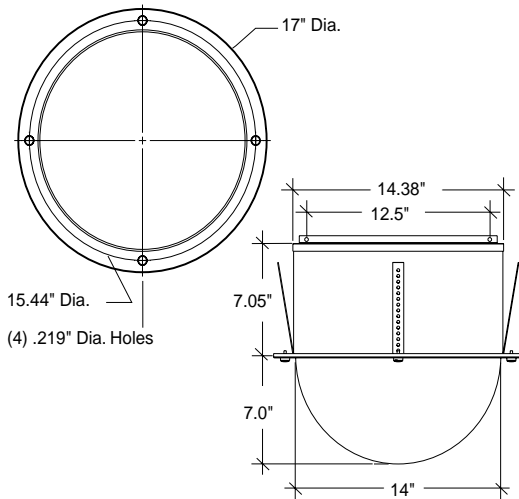

WIRING REQUIREMENTS FOR VLPT355/360 PAN/TILT

Gauge	Maximum Distance		VLC200 CoaxLynx™
	VLC2/3 Hardwire Control	VLC200 CoaxLynx™	
12	Single Common	Double Common	665
14			429
16	480	960	260
18	300	600	162
20	180	400	100
22	120	250	63

ELECTRICAL SPECIFICATIONS

Power Source - 24 VAC

Pan/tilt Power Consumption - 16 vA (max), .625 Amps P/T

Maximum load - 5 lb balanced

Scanner - 24 VAC/ .3 Amps

WITH PAN/TILT RECEIVER

(VLPT355/360 fixed speed versions)

Power Source - 24 VAC

Power Consumption: 30 Watts (Max), 1.25 Amps

Electronic Auto Pan - Standard

Construction - All aluminum body

(Continued on next page)

MODELS

MP121C - Indoor, recessed 12" clear dome housing with fixed camera bracket, clear lower dome. Includes decorative white trim ring.

MP121CK - MP121 with VLSC3 scanner

MP122D - Tinted, opaque dummy lower dome and decorative white trim ring. No camera bracket

MP141C - Indoor, recessed 14" clear dome housing with fixed camera bracket, clear lower dome. Includes decorative white trim ring.

MP141CK - MP141 with VLSC3 scanner

Note: Replace "C" with "T" in model number for tinted dome (1 F-stop light reduction).

OPTIONS/ACCESSORIES

AL14 - Aluminum 2' x 2' beige ceiling plate

LN12F - Liner for 12" dome

RK14 - Rail kit

VLC2 - Single station pan/tilt control

VLC3 - Single station pan/tilt and auto iris zoom lens control

VLC200T - UL-listed pan/tilt, scanner, switcher control for desktop

SHIPPING SPECIFICATIONS

Model	Unit Weight	Shipping Weight	Shipping Box Dim.
MP121	18 lbs	30 Grd/40 Air	20 x 20 x 19

* Shipping weights depend on box dimensions.