

CAMERA/HOUSING PACKAGES

AP8 and AD8

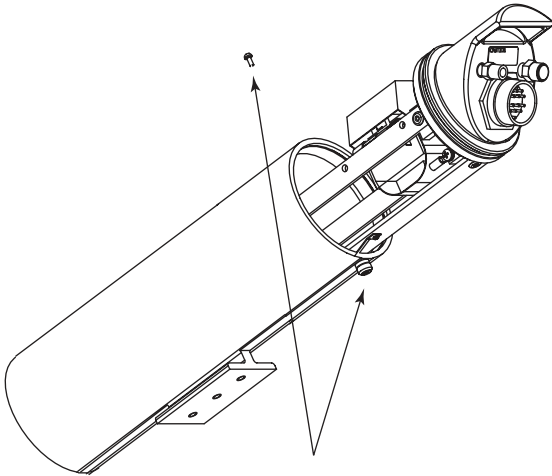

DESCRIPTION

The pressurized **AP8 and AD8** aluminum outdoor housings offer outstanding protection for the camera from dust, moisture, insects, and pollution. In-the-field pressurization is easy for the AP8 with the Schraeder valve included on each unit. The AP8 and AD8 both include a hi-res color camera with 23x zoom, auto iris lens.

PRODUCT FEATURES

- Hi-res color camera with 23x, auto iris lens
- Aluminum body, glass window
- Integrated heater/defogger
- Multi-pin, corrosion resistant connectors (AP8)
- Three liquid tight fittings for wiring (AD8)
- Non-volatile memory stores all settings in the event of a power loss

- Optional sunshield
 - Optional metal mount
 - Control with RS232 input via a Windows based laptop using software provided
 - Future enhancements include control via PDA and RS485 control with Videolarm and other manufacturer's protocols.
- Call Videolarm for more information.

AP8 ARCHITECTURAL/ ENGINEERING SPECIFICATIONS

The AP8 environmental, pressurized housing shall be constructed from .16" (4mm) thick aluminum. The camera housing shall be sealed on both ends by radial pressure O-rings to create a tight seal. Front to back motion shall be prevented by a retaining ring in the front and screws in the back. Chemically strengthened glass shall be used for the faceplate. The housings shall contain a single corrosion resistant connector for power, video, and external sync, and a mating connector shall be provided for the camera. The camera shall be fixed hi-res color with 23x zoom, auto iris lens. The camera shall have a horizontal resolution of 470 horizontal TV lines. Input power shall be 24 VAC. A camera cradle assembly shall be included to allow easy installation and access to the camera and internal equipment. The housings shall be fitted with a standard Schraeder valve for pressurization with 5 lbs. positive pressure of dry nitrogen. An over pressurization safety relief valve shall be mounted on each unit. An integral heater/defogger shall be standard in each unit and shall be mounted to the camera cradle to allow heat transfer to the window to minimize fogging in high humidity and/or freezing under cold temperature conditions. The temperature range shall be -40° F to +120° F. An aluminum sunshield shall also be available as a separately boxed items. This unit shall be FCC Part 15 approved.

AD8 ARCHITECTURAL/ ENGINEERING SPECIFICATIONS

The AD8 environmental, dust free housing shall be constructed from .16" (4mm) thick aluminum. The camera housing shall be designed to prevent dust from entering the unit. Chemically strengthened glass shall be used for the faceplate. Three liquid tight fittings (2 NPT 1/2" and 1 NPT 3/8") shall be included for cable entry. The camera shall be fixed hi-res color with 23x zoom, auto iris lens. The camera shall have a horizontal resolution of 470 horizontal TV lines. Input power shall be 24 VAC. A camera cradle assembly shall be included to allow easy installation and access to the camera and internal equipment. Input power shall be 24 VAC. An integral heater/defogger shall be standard in each unit and shall be mounted to the camera cradle to allow heat transfer to the window to minimize fogging in high humidity and/or freezing under cold temperature conditions. The temperature range shall be -40° F to +120° F. An aluminum sunshield shall also be available as a separately boxed items. This unit shall be FCC Part 15 approved.

CAMERA	
Image Sensor	1/4" interline transfer CCD
Output	NTSC
Number of Effective Pixels	Approx. 380,000 pixels
Resolution	470 (H) x 400 (V) TV lines
Lens	23x optical (f=3.6mm - 82.8mm)
Digital Zoom	10x (230x with optical zoom)
Angle of View	(H) 54° (wide) to 2.5° (tele)
Minimum Illumination	Color B&W
	3 lux @ 1/60s, .2 lux @ 1/4s 0.02 lux (1/4s, IR cut filter removed)
S/N ratio	50 dB
Electronic Shutter	Auto/Manual (manual 1/2s - 1/30000s)
White Balance	Auto/Manual
Automatic Gain Control	Auto/Manual (-3 to 28 dB, 16x 2 dB steps)
Iris Control	Auto/Manual
Backlight Compensation	On/Off
Focusing System	Auto/Manual
Low Light IR Mode	Auto/Manual
Privacy Zone	On/Off

GENERAL SPECIFICATIONS

Construction: Extruded aluminum housing, rear end & front cap
 Finish: White powder coat
 Viewing Window: 120" (3 mm) thick glass, optically clear, heat treated
 Weather Resistance: Tested to IP67 requirements
 Weight: 3 lbs (1.4 kg)

MODELS

AP8C-8 - Pressurized outdoor fixed camera system with 23x day/night camera, auto iris lens, and heater. 24 VAC input

AD8C-8 - Dust free outdoor fixed camera system with 23x day/night camera, auto iris lens, and heater. 24 VAC input

OPTIONS/ACCESSORIES

APM16 - Pole mount adapter

VLAY8 - Sunshield

WM1600 - Metal wall mount

ELECTRICAL SPECIFICATIONS

Power Input - 24 VAC, 50/60 Hz

Power Consumption - 18 watts (750mA)

ENVIRONMENTAL SPECIFICATIONS

Temperature range: -40° F to +122° F

CERTIFICATIONS

FCC Part 15 approved

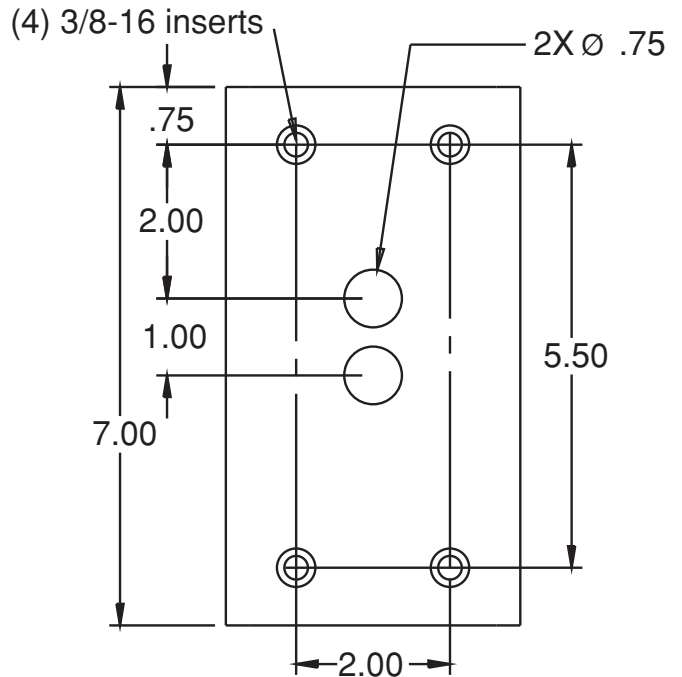
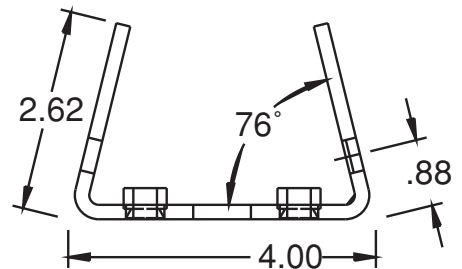

WM1600 - Metal wall mount

APM16 - Pole mount adapter